

Cleerly's Proxy solution allows secure, high-performance data transfer between Cleerly and the health data systems deployed at a hospital, provider site, or imaging center facility. This can be used to automate the upload of CCTA studies from your local systems to Cleerly's cloud service and the delivery of Cleerly reports to a PACS, RIS, and/or EHR. A single Cleerly Proxy installation can be used as an endpoint to receive studies from one or more imaging modalities, PACS, VNA solutions, DICOM Routers, or AI Orchestrators and then upload each study into the Cleerly service organizations for one or more providers. Proxy can also automate delivery of Cleerly's reports back into any compatible PACS, RIS, or HL7-compliant EHR/EMR.

Cleerly Proxy can be deployed as either a dedicated VPN tunnel to Cleerly cloud services, or as an on-site "virtual appliance" running on a local computer. The Cleerly implementation team will work with you to determine the best configuration based on local IT and security requirements.

Cleerly Proxy VPN

The Cleerly Proxy VPN uses a 24/7 dedicated VPN uplink between a system at the medical site and Cleerly's cloud service. The VPN link can be configured on any existing Windows system or on client networking equipment using the standard OpenVPN or IKEv2 protocols. The VPN is only used for data transfer, not remote access.

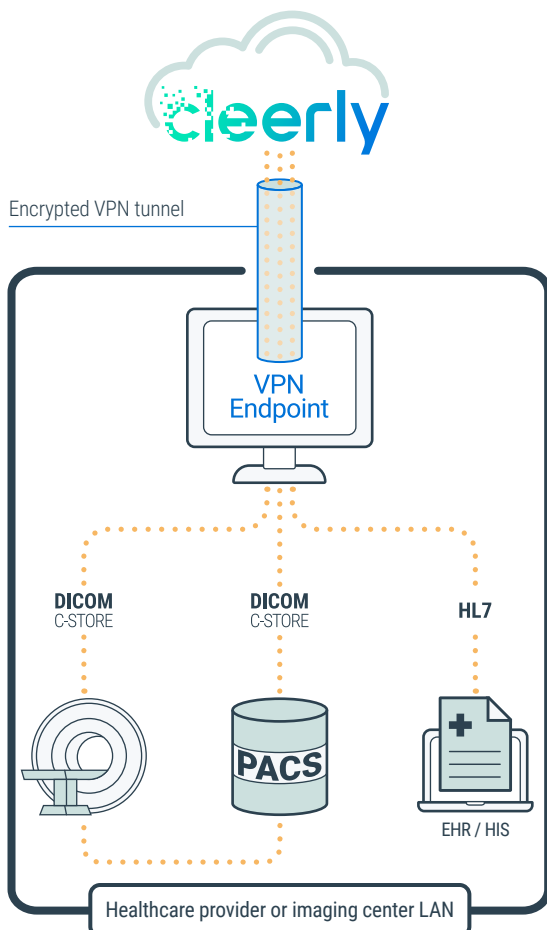

Cleerly Proxy Virtual Appliance

The Cleerly Proxy Virtual Appliance configuration deploys an on-site "virtual appliance." This pre-hardened virtual machine can be installed on either Windows (with Oracle VirtualBox) or VMware ESXi. The local VM transfers data to cleerly on demand via encrypted (TLS 1.2) transfers to AWS.

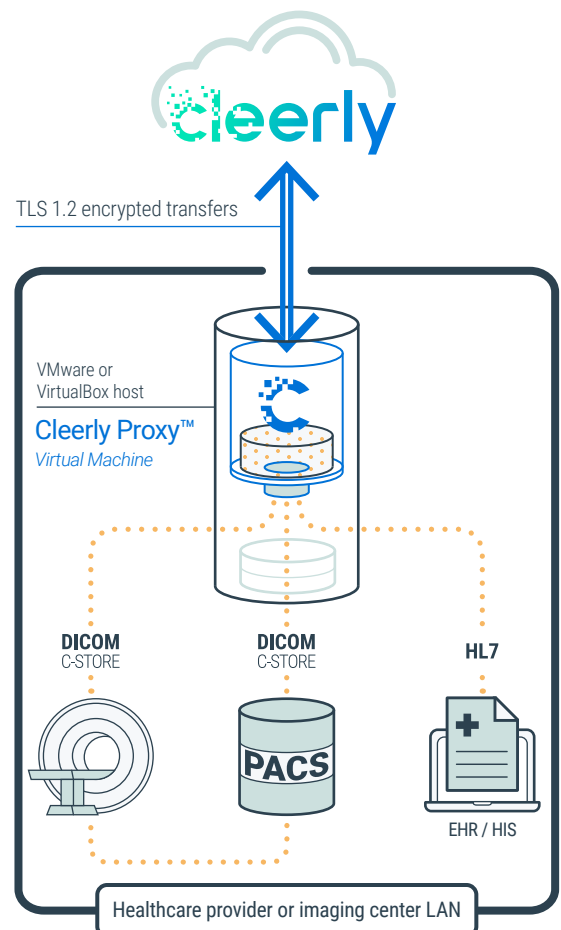

Comparison	Proxy VPN	Proxy Virtual Appliance
Advantages	Low footprint install Less software on-site to maintain	No dedicated network link needed Data transferred only when used Faster transfers for single-threaded modalities
Technical requirements	OpenVPN Connect or built-in IKEv2 300MB RAM Network access to DICOM system(s) Always-on network access to Ceerly No local storage requirements	Windows VirtualBox or ESXi cluster 4GB RAM 60GB disk space Network access to DICOM system(s) Network access to AWS (port 443)
Security	Standard encrypted VPN protocols TLS-based handshake AES 256 session keys	TLS 1.2 HTTPS data transfers to Ceerly Appliance built on minimal Debian Linux Mirth Connect HIE Hardened against CIS Benchmark
HIPAA	Compliant under BAA	Compliant under BAA
Pricing	Ceerly Proxy is provided without additional charge to clients of the Ceerly service.	

A New Standard for Cardiovascular Care

Ceerly is a digital healthcare company transforming the way clinicians approach the treatment of heart disease. Our clinically-proven, AI-based digital care platform works with coronary computed tomography angiography (CCTA) imaging to help clinicians precisely identify and define atherosclerosis earlier, so they can provide personalized, life-saving treatment plans for all patients throughout their care continuum.



Ceerly Labs is a web-based software application that is intended to be used by trained medical professionals as an interactive tool for viewing and analyzing cardiac computed tomography (CT) data for determining the presence and extent of coronary plaques (i.e. atherosclerosis) and stenosis in patients who underwent Coronary Computed Tomography Angiography (CCTA) for evaluation of CAD or suspected CAD.

Ceerly, Inc. © 2023 | All rights reserved | Reproduction, adaptation, or translation of this document is prohibited without prior written permission of Ceerly, Inc.

ceerly-pds-prxy-20230803